

specbolt

Dirtbike & ATV fastener kits

To order or ask about specific Motorcycle or ATV bolt kits you can call us anytime at 770-363-6580.

This is where we will teach you all about fasteners. Everything from properly measuring a bolt to the different head styles and grade ratings system of metric fasteners. This information can come in handy when you are trying to order a certain size bolt. Giving us the correct size ensures that we send you the right size.

METRIC BOLT MEASUREMENT

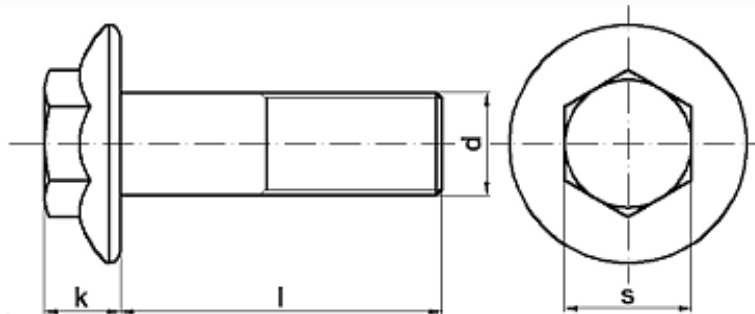

To measure a flange bolt's length (l) measure from the bottom of the head to the end of the bolt. This measurement is in mm.

To measure a Hex or flange bolt's diameter (d) measure across the thread of the bolt. This measurement is also in mm.

METRIC THREAD PITCH

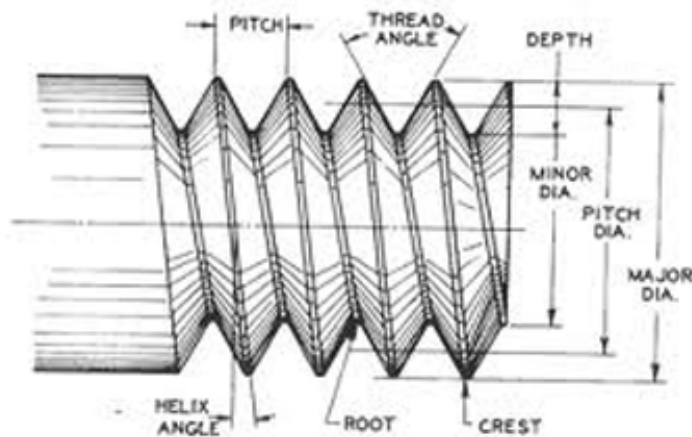

The common metric thread pitch for motorcycle and ATV uses are M4-.7, M5-.8, M6-1.0, M8-1.25, M10-1.5, M12-1.75, M14-2.0 and M16-2.0. Where the first number indicates the shank size in mm, the second number indicates the thread pitch in mm.

For example M10-1.50 indicates a 10mm thread diameter **with the spacing between the adjacent "peaks" of the threads = 1.50 mm.**

Typically a metric bolt's size is stated like this....

M(d/diameter)-pitch x(l/length)

For example if a bolt's diameter is 8mm with a pitch of 1.25 and a length of 25mm.

The bolt size is a M8-1.25x25





METRIC GRADES

Specbolt uses 10.9 grade which meets and usually exceeds motorcycle and ATV manufacturer's specs.

If we want to approximately compare metric grades to U.S. grades, a metric 8.8 is roughly equivalent to a Grade 5. Grade 10.9 is roughly equal to a Grade 8; and 12.9 is roughly equal to a Grade 9. Metric nuts are marked with a single or double numerical symbol (8, 10 or 12). Always match bolts and nuts of comparable grades (use a Grade 8 nut with a Grade 8 bolt; use a metric grade 10 nut with a 10.9 grade bolt, etc.). When dealing with metric fasteners, the 8.8 bolts are similar to a Grade 5. If you need higher tensile strength in metric, stick to 10.9 or 12.9.

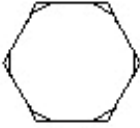
The higher the first number, the stronger the bolt in terms of tensile strength.
The higher the second number, the longer it will take to enter the yield point.

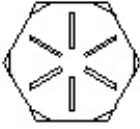
Note: Metric steel bolts are only required to show a grade mark if they are 6mm and larger and/or are Grade 8.8 or higher. Nuts must be grade labeled if they are Grade 8 or higher.

Grade Markings and Properties						
Identification Markings (Fasteners may also have manufacturer I.D. markings)	Specification	Material	Nominal Size Range (inches)	Mechanical Properties		
				Proof Load (psi)	Minimum Yield Strength (psi)	Minimum Tensile Strength (psi)
SAE Inch						
 No Markings	Grade 2	Low or Medium Carbon Steel	1/4 thru 3/4	55,000	57,000	74,000
			Over 3/4 thru 1-1/2	33,000	36,000	60,000
 3 Radial Lines	Grade 5	Medium Carbon Steel, Quenched and Tempered	1/4 thru 1	85,000	92,000	120,000
			Over 1 thru 1-1/2	74,000	81,000	105,000
 6 Radial Lines	Grade 8	Medium Carbon Alloy Steel, Quenched and Tempered	1/4 thru 1-1/2	120,000	130,000	150,000
Stainless markings vary. most stainless steel is non-magnetic	18.8 Stainless and A-2 Metric	Steel alloy with 17-19% Chromium and 8-13% Nickel	1/4 thru 5/8		80,000 – 90,000	100,000 – 125,000
			3/4 thru 1			100,000
			Above 1		45,000 – 70,000	80,000 – 90,000
ISO / DIN Metric						
 8.8	Class 8.8	Medium Carbon Steel, Quenched and Tempered	All Sizes thru 1-1/2	85,000	92,000	120,000
 10.9	Class 10.9	Alloy Steel, Quenched and	All Sizes thru 1-1/2	120,000	130,000	150,000

10.9	Tempered				
Tensile Strength: The maximum load in tension (pulling apart or shearing which a material can withstand before breaking or fracturing).					
Yield Strength: The maximum load at which a material exhibits a specific permanent deformation					
Proof Load: An axial tensile load which the product must withstand without evidence of any permanent set.					

To ask us about a specific ATV or Motorcycle bolt kit email direct to specbolt@gmail.com or call us anytime at 770-363-6580.

For modern and vintage ATVs and Dirt Bikes

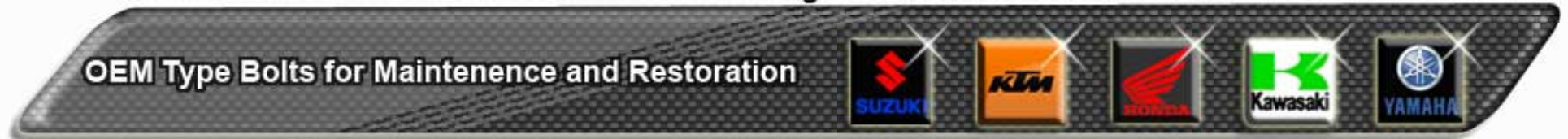

[HOME](#) | [STORE](#) | [PRODUCTS](#) | [ABOUT US](#) | [RIDERS](#) | [TECHNICAL](#) | [FAVORITES](#) | [CONTACT](#)